

THE PHOENIX PLAZA

EXPLORE A **REFINED** WORKPLACE

TOWER I - 2901 North Central

11th FLOOR



NORTH

NOT TO SCALE

All measurements are approximate

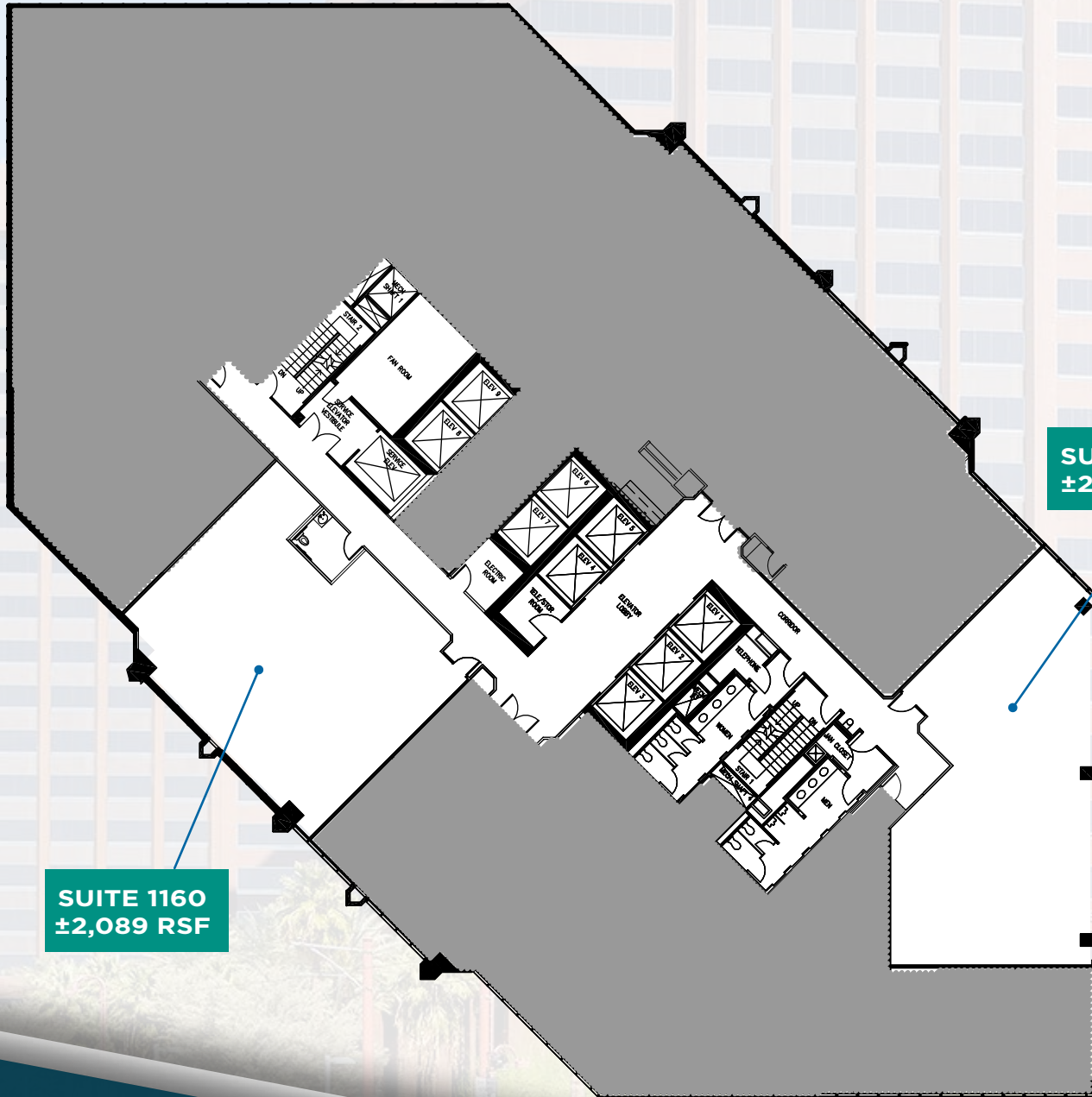

SUITE 1160
±2,089 RSF

SUITE 1120
±2,184 RSF

FOR MORE INFORMATION PLEASE CONTACT:

Jerry Roberts
+1 602 229 5829
jerry.roberts@cushwake.com

Pat Boyle
+1 602 229 5828
pat.boyle@cushwake.com

cushmanwakefield.com | 2555 E Camelback Rd, Suite 400 | Phoenix, AZ 85016

© 2018 Cushman & Wakefield All rights reserved. This information has been obtained from sources believed reliable, but has not been verified for accuracy or completeness. Any projections, opinions, or estimates are subject to uncertainty. The information may not represent the current or future performance of the property. You and your advisors should conduct a careful, independent investigation of the property and verify all information. Any reliance on this information is solely at your own risk. Cushman & Wakefield and the Cushman & Wakefield logo are service marks of Cushman & Wakefield and/or its affiliated or related companies in the United States and other countries. All other marks displayed on this document are the property of their respective owners. Photos herein are the property of their respective owners and use of these images without the express written consent of the owner is prohibited.



STATE STREET
GLOBAL ADVISORS